



**IMPORTANT**  
Installation Instructions

**IMPORTANTE**  
Instrucciones de Instalación

**IMPORTANT**  
Instructions d'Installation

© 2018 1B5990740A

**Tools Needed**

Herramientas requeridas

Outils requis

1/2" (13 mm)

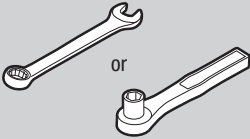

**Hardware Kit Includes**

El kit de instalación incluye

Le kit de matériel inclut

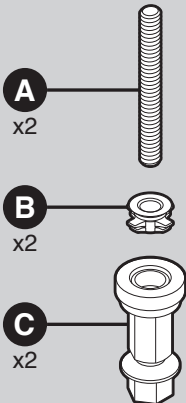

**1**

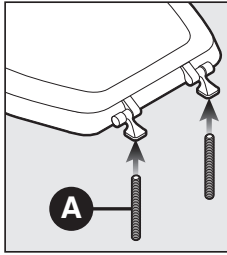

**Thread (A) into hinges.**

Enserte (A) en bisagras.

Visser (A) dans les charnières.

**2**

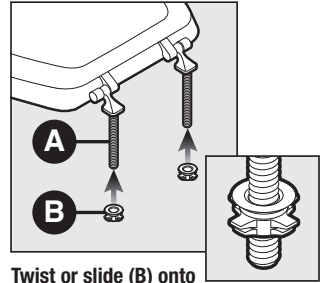

**Twist or slide (B) onto (A) all the way up.**

Gire o deslice (B) hacia (A) completamente hacia arriba.

Torsader ou glisser (B) sur (A) à fond.

**3**

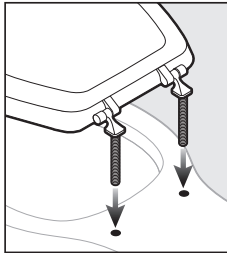

**Place seat on bowl.**

Colocar el asiento en el sanitario.

Placez le siège sur la cuvette.

**4**

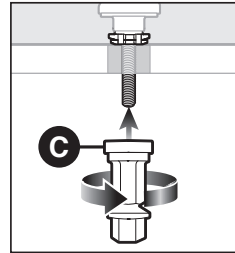

**Finger tighten (C) to the under side of the bowl.**

Aprieta con los dedos (C) en el lado inferior de la taza.

Serrer à la main (C) au-dessous de la cuvette.

**5**

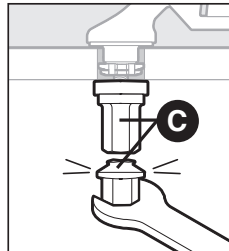
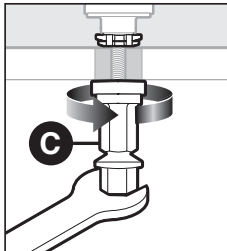

**Holding seat centered on bowl, tighten (C) until lower portions snap off.**

Sosteniendo el asiento centrado en la taza, apriete (C) hasta que las partes inferiores se desprendan.

En maintenant le siège centré sur la cuvette, serrer (C) jusqu'à ce que les portions inférieures cassent.