



HAVEN 1000

OWNER'S MANUAL





PRODUCT INFORMATION

Safety Precautions.....4
Parts.....6
Product.....7
Dimensions.....8
Controls.....9

INSTALLATION

Installation.....10

HOW TO USE

How to Use.....14
Maintenance & Cleaning.....22
Settings.....24
Troubleshooting.....25
Specifications.....26

WARRANTY

Warranty.....27



IMPORTANT SAFEGUARDS

- When using electrical products, especially when children are present, basic safety precautions should always be followed.

READ ALL INSTRUCTIONS BEFORE USING

- For use with 120V 60Hz: Power supply must be a 15 Amp GFCI outlet.
- The electrical cord must be connected to a GFCI outlet.
- The GFCI outlet should be 1 ft. above the floor.
- Install only in well-ventilated areas to avoid excess humidity.
- Do not install in narrow toilet stalls or in shower stalls.
- Install only where direct contact with water is minimized.
- Do not install near any heat source.
- Avoid using extension cords if possible. Consult with a certified electrician where extension cords are necessary.

DANGER - TO REDUCE THE RISK OF ELECTROCUTION

- Do not use while bathing.
- Do not place or store products where it can fall or be pulled into a tub or sink.
- Do not place in or drop into water or other liquid,
- Do not reach for a product that has fallen into water. Unplug immediately.

WARNING - TO REDUCE THE RISK OF BURNS, ELECTROCUTION OR INJURY TO PERSONS:

- Close supervision is necessary when this product is use by, on, or near children.
- Use this product only for its intended use as described in this manual. Only use attachments recommended by the manufacturer.
- Never operate this product if it has a damaged cord or plug, if it is not working properly, has been dropped or damaged, or dipped into water. Return the product to a service center for examination and repair.
- Keep the cord away from heated surfaces.
- Never drop or insert any objects into any opening or hose.
- Do not use outdoors or operate where aerosol (spray) products are being used or where oxygen is being administered.
- Connect this product to a properly ground outlet only. See grounding instructions.
- Unplug this product before filling. Fill (reservoir) with water only.



Top Mount Metal Bolt
(x2)



Top Mount Rubber Nut
(x2)



Washer
(x2)



T-Valve 7/8"

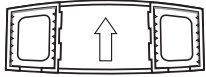

Catch Plate

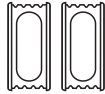

Bracket Holder



Water supply hose

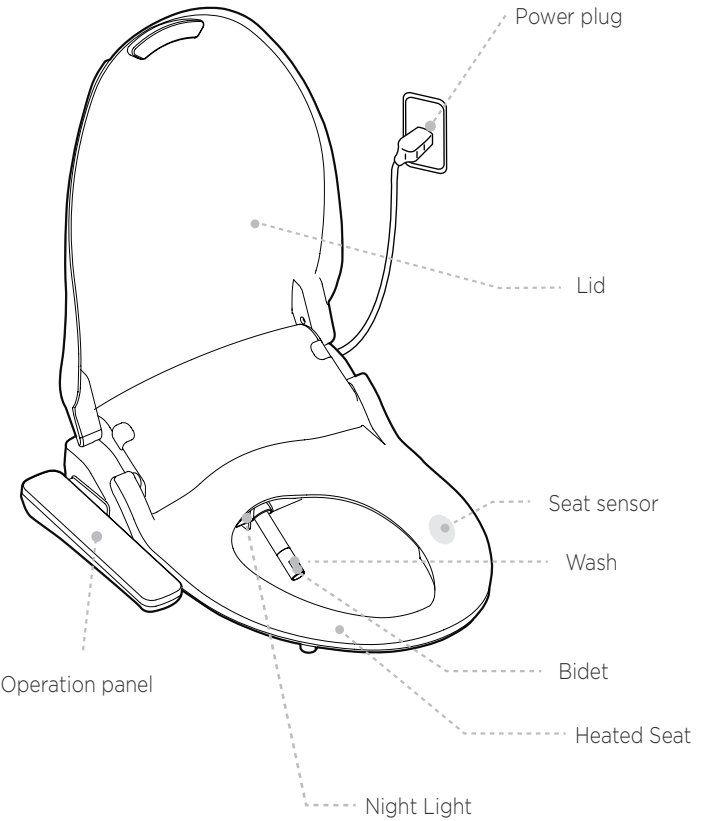

Toilet Seat type	Distance A
Round	16.9 – 17.7" (430 – 450mm)
Elongated	17.2 – 18.1" (450 – 470mm)

Elongated type

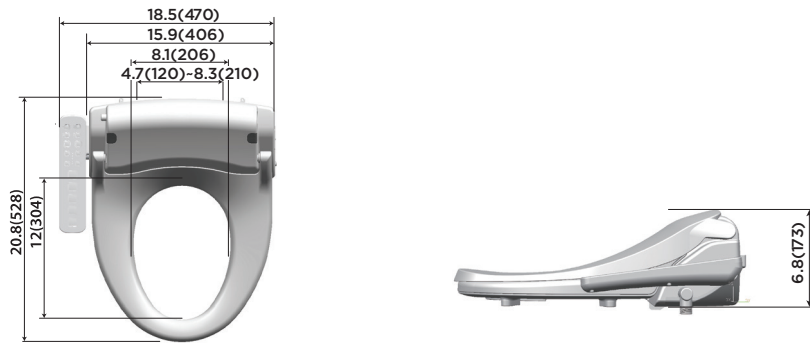

NOZZLE CLEANING

Activate while not seated.
The nozzle cleans itself 3 times and extends for manual cleaning.

SEAT TEMP

Adjust the seat temperature.
(off/low/mid/high)

MASSAGE

Activate the pulse function during Wash/Feminine/Turbo operation

< / >

Adjust the nozzle position.

TURBO

Start the Turbo function. (1 minute)

WASH

Start the Wash function. (1 minute)

ENERGY SAVING

1st: Automatic mode
2nd: Powerful mode
3rd: Off

WATER TEMP

Adjust the water temperature.
(off/low/mid/high)

CHILD

Activate the child safety wash.

+ / -

- Adjust the water pressure.
- Adjust the dryer temperature.

DRY

Start the Dry function.
(3 minutes)

BIDET

Start the Bidet function. (1 minute)

STOP

Stop any operations.

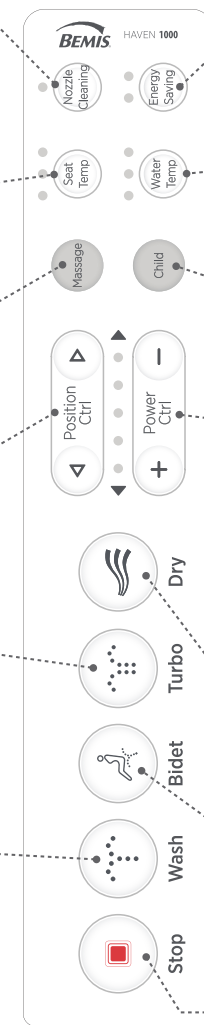

1. Remove the seat from the existing toilet body.

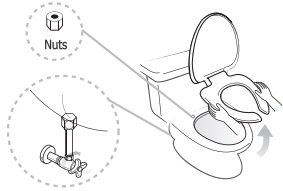

- Release the nuts, and then remove the seat and cover.
- Store the seat in a proper place for future use.
- Turn off the water.

2. Install the T-Valve.

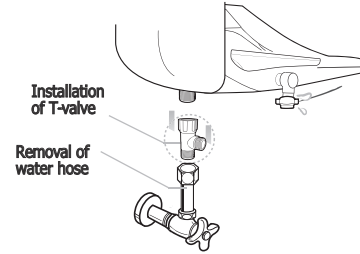

- Remove the existing water hose and then install T-valve to the bottom of the toilet tank. Ensure the rubber washer is properly seated and attach the original water hose to the T-Valve.

3. Fix the catch plate onto the toilet.

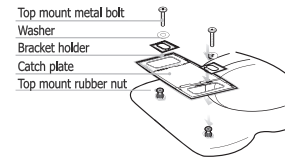

- Point the arrow on the catch plate towards the toilet tank.

4. Push the main body toward the catch plate completely.

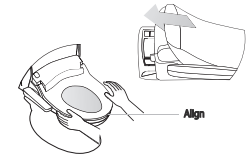

- Push it until you hear a “click”.
- When the product is not installed well, it may cause leakage.
- Adjust as needed before tightening bolts. Do not over tighten the bolts.

5. Connect bidet hose.

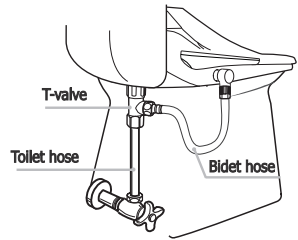

- After installing the T-valve, connect the supplied bidet hose from the center of the T-valve to the bidet.
- Connect the toilet hose to the bottom of the T-valve.

6. Turn on the water.

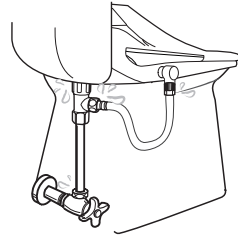

- Make sure to check for leaks.

7. Plug it in!



- Plug in and be sure that the nozzle comes out and retracts when powered on.
- Do not plug the power cord with wet hands. Risk of electric shock.

1. Sit On The Toilet Seat

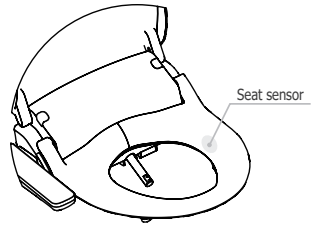

- Be sure to sit on the seat sensor. If the sensor is not occupied, all functions will not operate.
- Skin to seat contact needs to occur to activate seat.

2. Wash, Bidet, Turbo



- Selected function can be used as described.
- When pressing the selected function again, the nozzle will oscillate back and forth to wash a wider range.
- Press the button once again to stop oscillate function
- The specialized water spray in Turbo function helps relieve constipation.

3. Massage



- When pressing the Massage button during the operation of Wash, Bidet, and Turbo, water pressure will repeat high and low for smooth pulsating wash.
- Massage function will not operate during the operation of Sitz bath.

4. Child Function



- When selecting Child Function, settings adjust to low pressure.
- 1 min Bidet - 30 sec Bidet Oscillating - 30 sec Bidet Massage.
- It provides extra extended nozzle position, lower water pressure, lower seat temperature, lower water temperature.

5. Nozzle Position Control



- Nozzle position is adjustable (5 levels).

6. Water Pressure Control



- Water pressure is adjustable. (5 levels)
- If the water or screen filters become blocked, it may cause low water pressure. Regularly check the water and screens filters.

7. Stop



- All operations will stop.
- When pressing the stop button for 3 seconds, unit will turn off.
- Press Stop, Wash, Bidet, or Turbo to turn on.

8. Seat Temperature Control

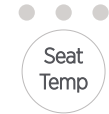

- Seat temperature is adjustable. (4 levels) (Off - Low - Middle - High)
- To reduce the chance of low temperature burns, the seat has a safety feature that turns to low temperature (35°C, 95°F) when seat is occupied for more than 15 minutes consecutively.
- If the seat is set lower than middle level, the seat will remain at off or low level.

9. Energy Saving Function



- Eco 1 - This mode will be activated by pressing the Energy Saving button until the yellow LED light turns on. (Seat and water temperature will be kept at 32°C)
- Eco 2 - This mode will be activated by pressing the Energy Saving button until the green LED light turns on.
- Eco OFF - Press the Energy Saving button until LED light turns off.
- When the unit is occupied, it adjusts to the present temperature and is returned to the saving mode when seat is unoccupied.
- If the seat and water temperature are off, they will remain off.

10. Nozzle Cleaning

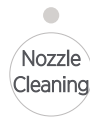

- When selecting Nozzle Cleaning while not seated, the nozzle cleans itself 3 times. Then nozzle extends and stop for manual cleaning process.
- Clean the nozzle with a brush and press the STOP button after completion of manual cleaning. Then nozzle cleans itself for 3 times and retracts.
- NOZZLE CLEANING will not operate if the seat sensor is activated.

11. Night Light



- Blue LED night light provides enough brightness to see the toilet without turning on the bathroom light. Night light can be turned on and off by pressing + for 3 secs while not seated.
- Night light setting cannot be adjusted if seat sensor bypass feature is activated.

12. Automatic Tank Draining



- Water temperature is adjustable. (4 levels) (Off - Low - Middle - High)

13. Sitz Bath



- Wash or Bidet is switched to Wash Sitz Bath or Bidet Sitz Bath if Nozzle Cleaning button is pressed during use.
- Water pressure is switched to 1st level regardless of preset water pressure settings and Sitz Bath operates for 5 minutes.
- LED of Nozzle Cleaning turns on during the operation of Sitz Bath.
- Select the Nozzle Cleaning again to switch to normal Wash or Bidet.

14. Seat Sensor Bypass



- The seat sensor can be activated and deactivated by pressing Massage button for 3 seconds.
- If the seat sensor is deactivated, the unit works without occupying the seat and select features cannot be controlled. Those features are Night light, Silent mode, and Nozzle cleaning.

15. Reset



- Press and hold the Stop button for 5 seconds.
- After 3 seconds, the seat will power off. Keep holding another 2 seconds and the seat will power back on. This completes the factory reset process.

16. Using Inline Carbon Filter

Use of external water filter is only recommended in areas with known hard water issues.

If a filter is used, it must be replaced every 3 months. This product is designed and intended for use exclusively with Bemis DIB water filters.

The purchase or use of any other water filter is not the responsibility of Bemis.

As such, any use of non DIB water filters is prohibited and will void the warranty for those Bemis products. Bemis will not be responsible for any resulting damages or claims related to the misuse or distribution of non Bemis DIB filters.

Screen Filter Cleaning

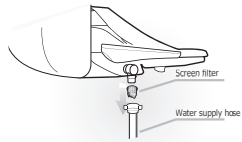

1. Close the water valve.
2. Disconnect the water supply hose. Take the screen filter out and clean it with a soft brush.
3. Return the filter after cleaning and reconnect the water supply hose.
4. Open the water valve.

Extended Non-Use



- When bidet seat is not used for an extended period of time, unplug and drain the unit.

Cleaning the Unit

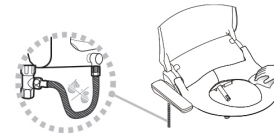

1. Exterior surface of unit is made of plastic material, which may be damaged by scrubber, chemicals, etc.
2. Wipe the surface with a soft damp cloth. Do not spray water directly onto the surface.
3. Clean the body after removing the power plug from the outlet. Be sure no water splashes into the power plug or outlet.
4. Be careful of not dropping any chemical detergents or toilet cleaner on the main body or supply hose to avoid damage.

Draining of Remaining Water

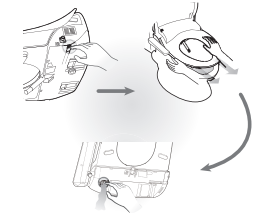

1. Remove the power plug from the outlet.
2. Close the water feed valve.
3. Press the release button and gently pull to remove the unit from the catch plate.
4. Use a flat-head screwdriver to open the drain plug.

USER SETTING WITH THE REMOTE CONTROL

● Seat sensor 'off' ○ Seat sensor 'on' ◐ Regardless of on/off

No.	Function	Seat Status	Switch Operation	Description	Initial Status
1	Silent mode	●	"⏻" For longer than 3 seconds	To turn on/off the operating chime sound.	ON
2	Power off	●	"⏻" For longer than 3 seconds	Press one of Stop, Wash, Bidet, Intensive or Dry to power on	
3	Seat sensor bypass	●	"⏻" For longer than 3 seconds	Seat sensor feature will be deactivated	OFF
4	Night light	●	"⏻" For longer than 3 seconds	To turn on/off the night light	ON
5	Factory reset	●	Press and hold the Stop button for 5 seconds	After 3 seconds, the seat will power off. Keep holding another 2 seconds and the seat will power back on. This completes the factory reset process	ON

- The unit will work without sitting on the seat if the occupied seat sensor is deactivated. (Turned off)
- If the seat sensor is deactivated, some features cannot be controlled. (Night light on/off, silent mode on/off, and nozzle cleaning)

PLEASE CHECK THE FOLLOWING POINTS BEFORE REQUESTING REPAIR SERVICE.

PROBLEM	CHECK LIST
Completely out of order	<ul style="list-style-type: none"> • Check if the power plug is not connected • Check if the power supply or outlet has failed
Water does not spray out	<ul style="list-style-type: none"> • Check if the water supply is turned on • Check if water valve is open • Check if nozzle is blocked by foreign material • Check if connection hose is bent
Water pressure is low	<ul style="list-style-type: none"> • Check if screen filter is blocked and clean if needed. • Check if the water pressure is set at too low level.
Water is not warm enough	<ul style="list-style-type: none"> • Check if its temperature is set at off or low level, or economy mode
Seat is not warm enough	<ul style="list-style-type: none"> • Check if its temperature is set at off or low level, or economy mode

Self-Diagnosis Table

Please refer to the following table and inform the exact status when requesting repair service.

No.	Self Diagnosis	Indication
1	Water temp sensor is disconnected or not inserted.	LEDs of water low + middle level blinking
2	Water temp sensor is short-circuited or overheated	LEDs of water high + middle level blinking
3	Seat temp sensor is disconnected or not inserted	LEDs of water low level blinking
4	Seat temp sensor is short-circuited or overheated	LEDs of water high level blinking



ITEM		BEMIS HAVEN 1000		
Rated voltage		120V, 60Hz		
Max. Power consumption		870W		
Power cord length		1.2 m		
Water feed method		Directly connects to water pipe		
Recommended inlet water pressure		9.95-106.7 psi		
Wash	Feed Volume	Wash	0.13-0.21 gal/min	
		Bidet	0.13-0.18 gal/min	
		Turbo	0.13-0.18 gal/min	
		Child	0.13-0.16 gal/min	
	Pressure control		5 levels	
	Temperature control		4 levels (off-low-middle-high)	
	Heater capacity		800W	
Safety device		Water level sensor, Thermal fuse, Bi-metal, Temperature sensor		
Heated Seat	Temperature control		4 levels (off-low-middle-high)	
	Heater capacity		55W	
	Safety device		Thermal fuse	
Feed water temp. tolerance range		37-95°F (recommended 54-95°F)		
Usage room temp. tolerance range		37-104°F (recommended 54-95°F)		
Dimension	Elongated	18.5"(470) x 20.8"(528) x 6.8"(173)		
Weight Net Weight (Gross weight)	Elongated	10.4 lb (15.2)		

1 YEAR WARRANTY

Your product is warranted against defects in materials or workmanship for (1) year from the date of original purchase. Defective parts or a defective products returned to Bio Bidet Innovation LLC will be repaired with new or comparable rebuilt parts or exchanged for a refurbished product as determined by Bio Bidet Innovation LLC in their sole discretion.

This limited warranty given by Bio Bidet Innovation LLC covers all defects encountered in normal product use, and do not apply in the following cases:

1. Loss of or damage to product due to abuse, misuse, tampering. Mishandling, improper packaging by you, alteration or fail to follow operating instructions.
2. Use of parts or supplies (other than those by Bio Bidet Innovation LLC dealers that cause damage to product.
3. Replacement of discolored or stained parts caused by chlorine, bleach, ammonia and other chemicals, cleaning supplies, oxidation, normal wear and tear.
4. Damage to or malfunction of the unit as a result of improper and negligent installation.
5. Any and all damages to plumbing, walls, floors, ceiling and personal properties resulting from water leaks or breakage. The product must be used at the user's own risk. Therefore, the owner hereby releases the manufacturer and distributor from any and all claims for damages where the above condition exists.

No implied warranty, including any implied warranty of merchantability or fitness or a particular purpose, applies to Bio Bidet Innovation LLC bidet after the applicable period of the express limited warranty stated above, and no other express warranty or guarantee, except as mentioned above, given by any person or entity with respect to Bio Bidet Innovation LLC shall bind Bio Bidet Innovation LLC. (Some States and provinces do not allow limitations on how long an implied warranty, so the above limitation may not apply to you) Bio Bidet Innovation LLC shall not be liable for revenues or profits, inconvenience, expense for substitute equipment or service, or any other special, incidental or consequential damages caused by the use or misuse of, or inability to use product, regardless of the possibility and foresee-ability of such damages. In no event shall recovery of any kind against Bio Bidet Innovation LLC be greater in amount than the purchase price of the product and causing the alleged damage. Without limiting the foregoing, you assume all risk and liability for loss, damage or injury to you and your property and to others and their property arising out of use or misuse of, or inability to use, the product not caused directly by the negligence or Bio Bidet Innovation LLC. This limited warranty shall not extend to anyone other than the original purchaser of the product.

Thank You



300 Mill Street
Sheboygan Falls, WI 53085
T: 920.467.4621

Bidets@Bemismfg.com
ToiletSeats.com